

VILLAGE AT PALM COAST PHASE I AND II (TIDELANDS) SPECIFIC PURPOSE SURVEY – JOINT USE AREAS

INTRACOASTAL WATERWAY (500' R/W)

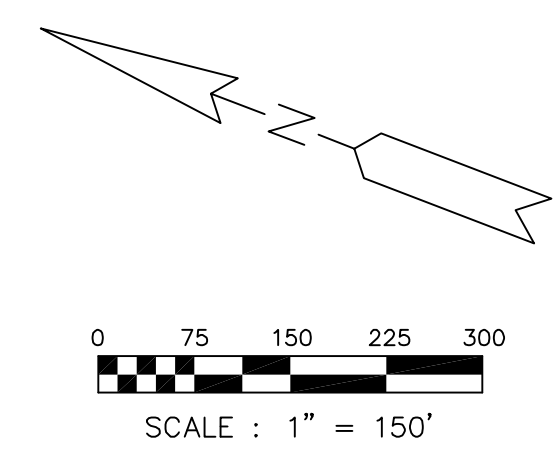
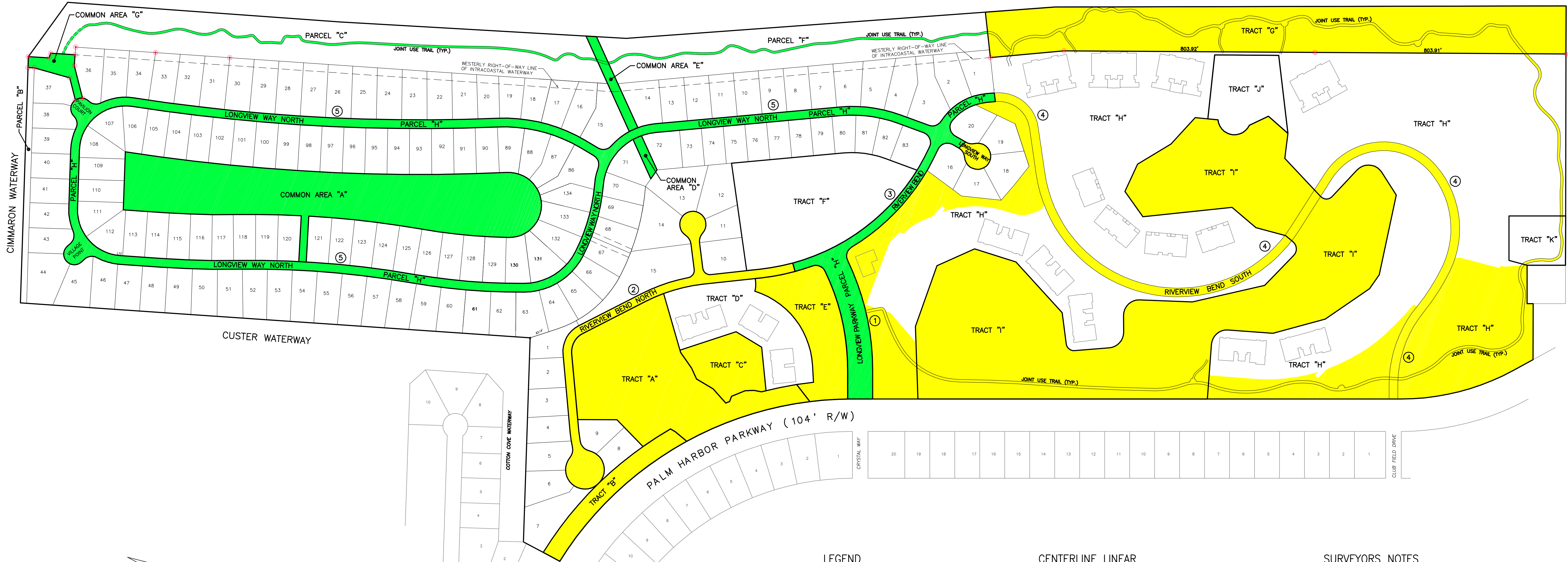

- LEGEND**
- JOINT USE AREAS FOR VILLAGE AT PALM COAST, PHASE I, AS RECORDED IN OFFICIAL RECORDS BOOK 1677, PAGE 1503, AND AMENDED IN BOOK 1706, PAGE 1467, PUBLIC RECORDS OF FLAGLER COUNTY, FLORIDA
 - JOINT USE AREAS FOR VILLAGE AT PALM COAST, PHASE II (TIDELANDS) AS RECORDED IN OFFICIAL RECORDS BOOK 1677, PAGE 1503, AND AMENDED IN BOOK 1706, PAGE 1467, PUBLIC RECORDS OF FLAGLER COUNTY, FLORIDA

• STAKED CORNER IN FIELD

- CENTERLINE LINEAR FOOTAGE**
- ① - 481.61 L.F.
 - ② - 1495.49 L.F.
 - ③ - 533.08 L.F.
 - ④ - 3164.59 L.F.
 - ⑤ - 5291.17 L.F.

SURVEYORS NOTES

1. THIS SPECIFIC PURPOSE SURVEY WAS PREPARED TO SHOW JOINT USE AREAS AND FIELD STAKING IN AREAS SPECIFIED BY THE CLIENT.
2. THERE MAY BE ADDITIONAL EASEMENTS, RESTRICTIONS AND/OR OTHER MATTERS NOT SHOWN HEREON THAT MAY BE FOUND IN THE PUBLIC RECORDS OF FLAGLER COUNTY, FLORIDA.
3. THIS IS NOT A BOUNDARY SURVEY.

PROJECT MANAGER: PM, FIELD BOOK INFORMATION: FBK, P:\V\5001\01\2000-DATA\TIDELANDS_SPS.DWG - LAYOUT1 - PLOTTED 8/27/2012 2:08 PM BY: KUJAR, KEN

DATE: _____
KENNETH J. KUJAR, PROFESSIONAL SURVEYOR #6105
WADE TRIM, FLORIDA LICENSED BUSINESS #7565

WADETRIM
5 Utility Drive, Suite 4
Palm Coast, FL 32137
386.446.5633 FAX: 386.446.5408
Certificate of Authorization No.: 3952
www.wadetrtrim.com

Building relationships on a foundation of excellence

© Wade Trim Group, Inc.